

Basic equipment configuration: Filler A4001

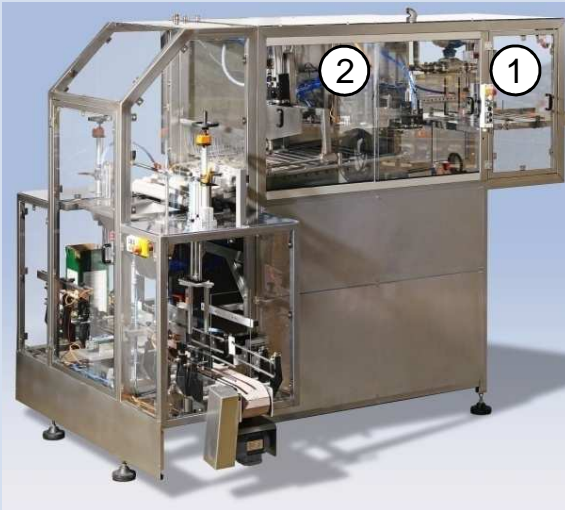

OP7



E-cabinet



Control cabinet



Pneumatic



IDM



CIP-adapter



Bag separation



Bag intake (1)



Filling chamber (2)

Basic equipment configuration: Bag loading station

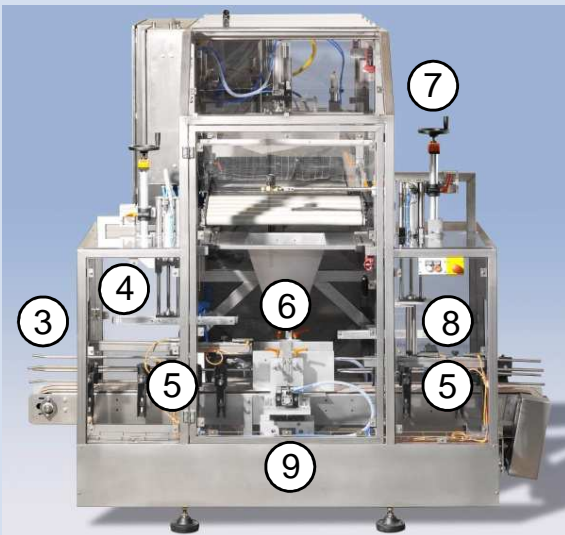

Coveyor belt (3)



Spreader (4)



Singularisation (5)



Bag funnel (6)

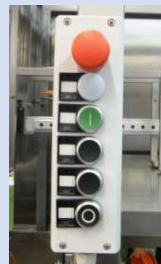

Operating panel



Hand wheel (7)



Tap positioner (8)



Lifting station (9)

Performance:
3 litre up to 960 bags/hour
5 litre up to 840 bags/hour
10 litre up to 540 bags/hour

Technical Data
Filling range: 3 ... 20 litres
Compressed air pressure: 6 bar (Festo-components)
Voltage/power: 400V (50Hz)/ 25A
Control voltage: 24V

- Can be used to process nearly all liquids
- Robust stainless steel construction
- High-quality equipment components (Siemens, Festo, SEW)
- Good operability
- Maintenance friendly design allowing good accessibility
- Pre-settable program modes (CIP, forward running, production, maintenance)
- Exact machine settings via the hand wheel
- High operational availability through precise component processing
- Format change within just a few minutes
- Pre-programmed filling quantities via selection switch on operating box
- Remote maintenance via modem
- The machine conforms to EC Machinery Directive 2006/42/EC

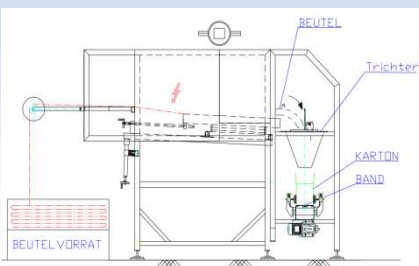

Dimensions L/B/H: 3800/2300/2300

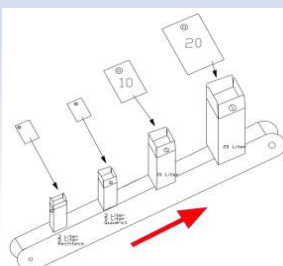

Cartons for 3, 5, 10 und 20 litres

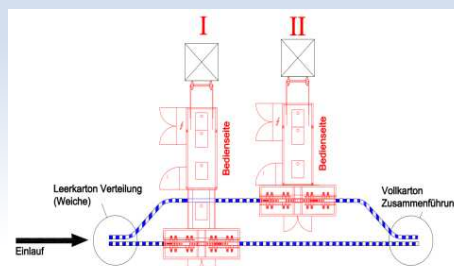

Illustration showing 2 filling machines



Standard sealing systems